

KaleidoCrete[™]

Operating Manual





Copyright© Compact 1000 1996

Revised September 1997

KaleidoCrete Edition Revised March 2001

KaleidoCrete Edition Revised March 2003

KaleidoCrete Edition Revised March 2007

KaleidoCrete Edition Revised January 2010

KaleidoCrete Edition Revised March 2016

by Engrave-A-Crete®, Inc.

403 North Oak

Mansfield, MO 65704

Phone 1- 800-884-2114 or 1-417-924-2300

Fax 1-417-924-2500

This entire system is copyright © 1996. Revised September 1997, 2007, 2010, 2018. All rights reserved. No part of this manual or system shall be reproduced, stored in a retrieval system, or transmitted by any means, electronic, mechanical, photocopying, recording, or by any information storage and retrieval system, or transmitted by email or otherwise, in any form or by any means without permission in writing from the author or from the publisher.

Although every precaution has been taken and all attempts have been made to verify information provided in this publication, neither the publisher nor the author assume responsibility for errors, inaccuracies, omissions or contrary interpretation of the subject matter herein. Neither is liability assumed for damages resulting from the use of the information contained herein.

This publication is not intended for use as a source of legal or accounting advice. The publisher wants to stress that the information contained herein may be subject to varying state and/or local laws or regulations. All users are advised to retain competent counsel to determine what state and/or local laws or regulations may apply to the user's particular business. The purchaser or reader of this publication assumes responsibility for the use of these materials and information. Adherence to all applicable laws and regulations, both federal and state and local, governing professional licensing, business practices, advertising and all other aspects of doing business in the US, Canada or any other jurisdiction is the sole responsibility of the purchaser or reader. Neither the author nor the publisher assume any responsibility or liability whatsoever on the behalf of any purchaser or reader of these materials.

Engrave-A-Crete is a trademark registered in the U.S. Patent and Trademark Office.

KaleidoCrete™

Machines and methods are patented under one or more of the following Patents #5,176,426 and #5,445,437 Other patents pending.

Foreign registrations pending.

Table of Contents

Warnings and Precautions	4
Mochton Stylus “Barracuda”™	5
<i>Barracuda Parts List.....</i>	<i>6</i>
<i>Barracuda Service and Operations</i>	<i>7</i>
Mochton Stylus “Wasp”™	8
<i>Wasp Parts List</i>	<i>9</i>
<i>Mochton Wasp Service and Operations</i>	<i>10</i>
Methods of Cutting	11
<i>Definition of Template Parts</i>	<i>11</i>
<i>Cutting Integral Bridges</i>	<i>12</i>
<i>Cutting a Rotating Template Design.....</i>	<i>13</i>
<i>Cutting Repeating Patterns.....</i>	<i>14</i>
<i>Cutting Border Patterns.....</i>	<i>15</i>
<i>Cutting a Single Template</i>	<i>16</i>
<i>Cutting a Multi-Piece Pattern</i>	<i>17</i>
<i>Cutting a 2-Piece Template Set.....</i>	<i>19</i>
<i>Cutting a Half Template Pattern.....</i>	<i>20</i>
<i>Cutting an Ashlar Slate Template Pattern</i>	<i>21</i>
<i>Cutting a Flagstone Template Pattern</i>	<i>22</i>
<i>Cutting a Grout-line Template Pattern</i>	<i>23</i>
<i>Cutting a Fan Cobblestone Template Pattern.....</i>	<i>24</i>
<i>Cutting a River Rock Template Pattern</i>	<i>25</i>
Copyright Release and Information Form	26
IMPORTANT NOTICE: Concerning Copyrights.....	27

Engraving Operations

Warnings and Precautions

Exposure to vibration may be harmful to hands and arms.

Safety Note:

A gas powered air-compressor should never be operated indoors. When operating the Shark Engraver indoors, place the gas powered compressor out-of-doors. [Note that it is possible for the compressor to pick up the engine exhaust fumes and pump them indoors.] Orient the compressor so the air pump (compressor) is upwind or cross wind from the engine exhaust AND ventilate the building/work area well. Carbon Monoxide is colorless, odorless and dangerous.

When working with tools, equipment, and chemicals, always use proper safety equipment!

Before use

- Put a few drops of Shark oil through the air inlet.
- Always blow out the incoming airline to remove any dirt and debris.
- Maximum operating pressure is 90 p.s.i.
- For best results use a 3/8" diameter air hose. Keep air hoses short. If possible, do not use over 100 feet of hose behind the tool. For each additional 100 feet of hose, 1 cu. ft/min additional air should be allowed. As a rough guide, pressure drop is approximately 3 p.s.i. per 100 feet of hose.

Use PPE Person Protective Equipment

Including Goggles, Face Shield, Shock Absorbing Gloves and Ear Protection and Dust Mask

Barracuda 2.0

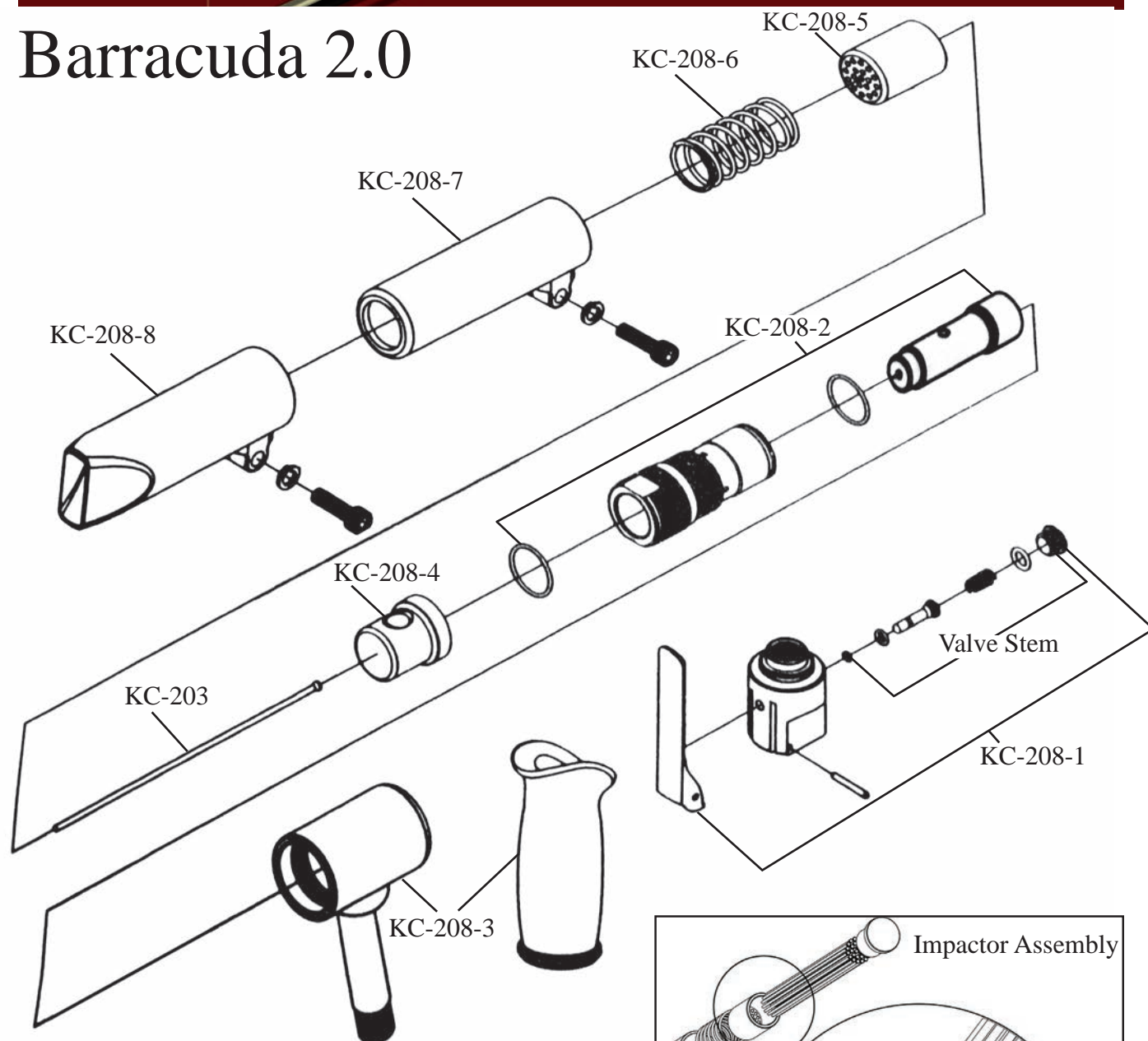

- KC-208-1 Valve Body and Stem
(Includes Body, Trigger Handle, and Pin)
- KC-208-2 Cylinder and Piston
- KC-208-3 Housing (Includes Handle Grip)
- KC-208-4 Anvil
- KC-208-5 Collett
- KC-208-6 Spring
- KC-208-7 Intermediate Tube
- KC-208-8 Front Tube
- KC-209-9 O-Ring Kit (Not Pictured)
- KC-203 Impactors

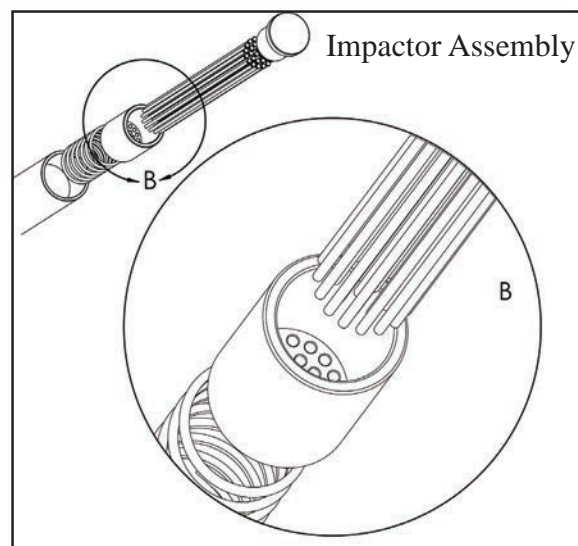

Barracuda Service and Operations

Impactors

Sometimes even a careful craftsman will snag a template or run off a slab and bend an impactor. Careful placement of the impactors into the template opening helps minimize damage. To straighten a bent impactor use a pair of needle nose pliers to grip the impactor and reshape it. This process can be done while the impactors are in the tool.

Tip: If a template has small details or intricate patterns try removing some of the teeth from the tool.

As impactors wear, the front tube (8) can be moved to expose additional length of impactors. Loosen the screw on the front tube clamp, adjust the length by sliding the front tube then tighten the screws on the clamp. Generally the length of teeth protruding from the front tube cap should be 3/4 to 1 inch.

Changing Impactors

Disconnect the air supply before changing or replacing the impactors. Loosen the hex cap screws on the upper - barracuda head clamp (26). Unscrew the entire front tube (8) and intermediate tube (7) assembly from the pneumatic assembly.

Take care to note how all the parts within the intermediate and front tube assembly fit together as incorrect assembly will result in damage to the tool when used.

Remove the anvil (4), collet (5), impactor (203), and spring (6) assembly from the intermediate tube (6).

Remove the anvil and spring from the assembly; turn the collet upside down to dump the impactors out.

Drop a handful of impactors into the collet and gently shake to get the impactors into the holes. Once all holes are filled with impactors insert the anvil into the collet and slide the spring over the impactors. Insert this assembly back into the intermediate and front tube assembly. Reattach to the pneumatics and tighten clamp.

Barracuda Oil Lubrication

Oil the Barracuda daily, before start and occasionally during the job. Apply a few drops of Air Tool Oil through the air inlet.

The use of an in-line lubricator/filter to the Barracuda is strongly recommended. This will ensure trouble free running and prolong the life of the Barracuda.

Mochton Stylus "Wasp"™

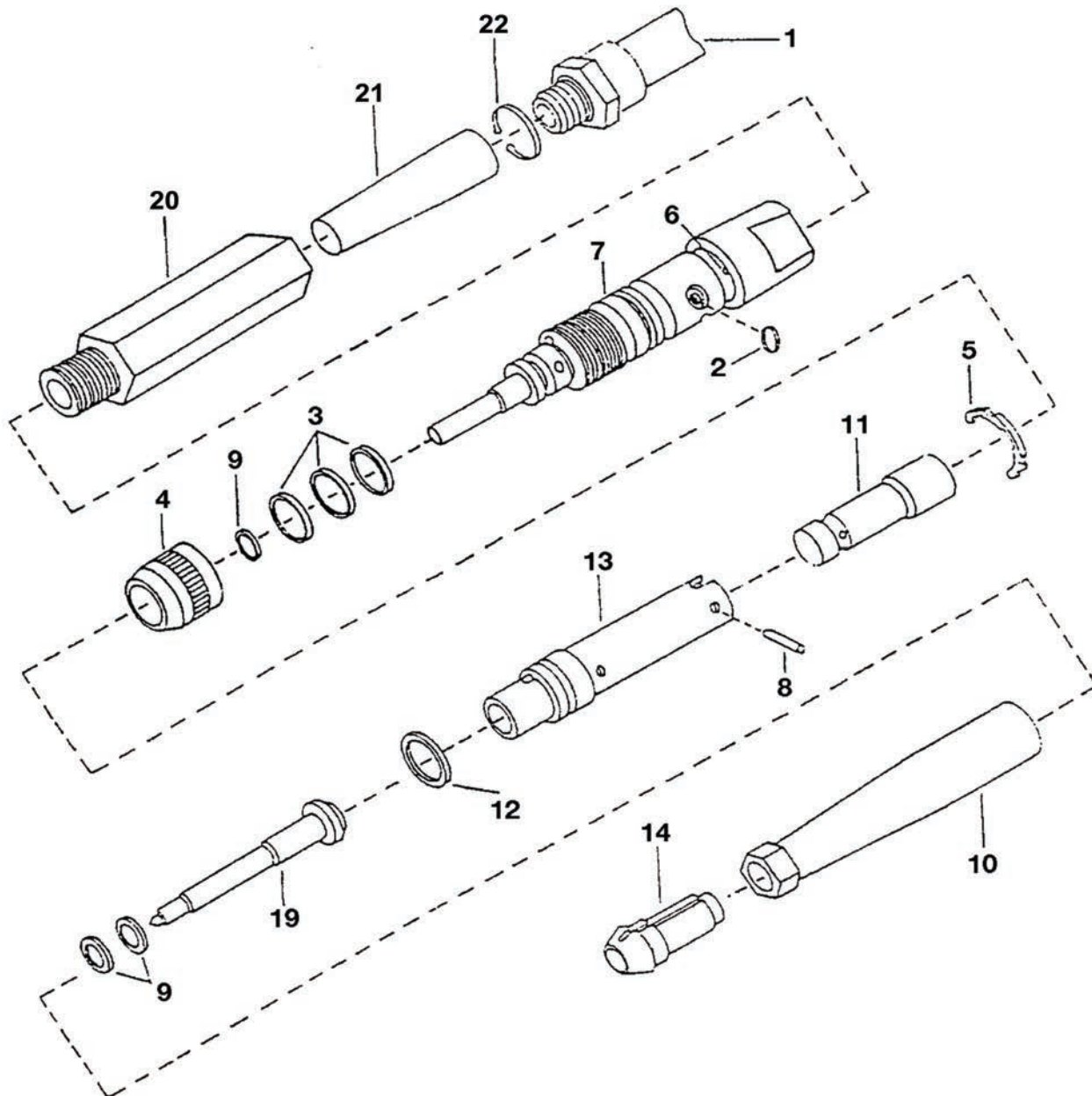

Wasp Parts List

INDEX NO.	DESCRIPTION	QTY
1	Air Hose	1
2	O-Ring	1
3	O-Ring	3
4	Valve Sleeve	1
5	Retaining Ring	2 (Halves)
6	Roll Pin	1
7	Inlet	1
8	Roll Pin	1
9	O-Ring	3
10	Cylinder Sleeve	1
11	Piston	1
12	O-Ring	1
13	Cylinder	1
14	Bushing	1
19	Stinger	1
20	Air Filter Body	1
21	Filter Cartridge	1
22	Retaining Ring	1



Mochton Wasp Service and Operations

Air Supply

For efficient performance, use a regulated air supply of clean dry air at 90 p.s.i. If the air supply is dirty or wet, in addition to the air filter included with the Wasp, an air line filter should be mounted at the compressor to remove contaminants. This will prevent premature clogging of the air filter included with the Wasp. The air supply should be carried in a minimum 3/8" I.D. hose.

Lubrication

Lubricate the Wasp daily by adding several drops of pneumatic air tool oil into the air inlet. Decrease lubrication volume but add frequency if excess oil blows out of tool. Do not allow oil to blow all over your concrete art work. For continuous lubrication, the use of a in-line lubricator is recommended.

To replace the stylus, disconnect the air supply, unscrew the cylinder and inlet assemblies from the cylinder sleeve. Shake the cylinder sleeve to remove the old stylus. Drop the new stylus in, point first. Finally, screw the sleeve and the assemblies back together until the sleeve touches the retaining ring.

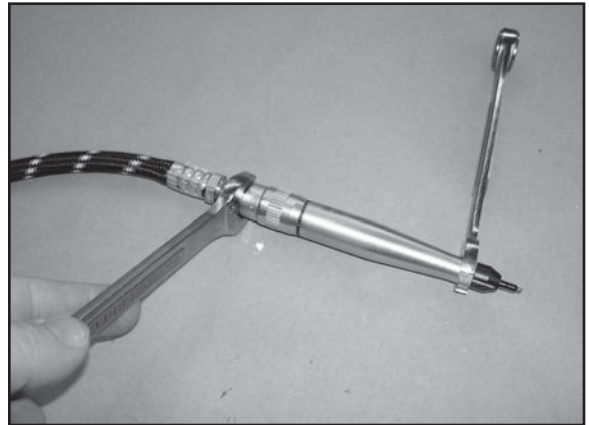

Approved safety glasses should be worn at all times when operating this or any other percussion tool.

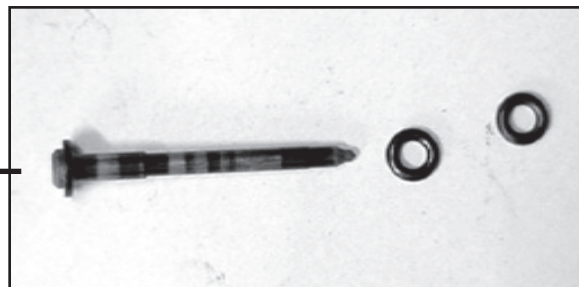
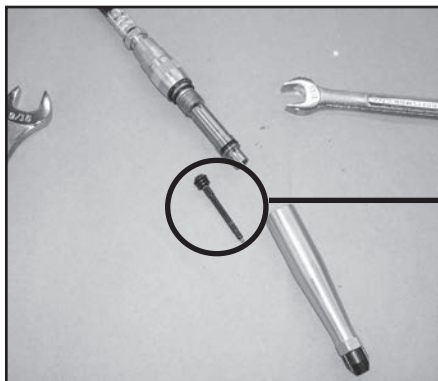

Methods of Cutting

Definition of Template Parts

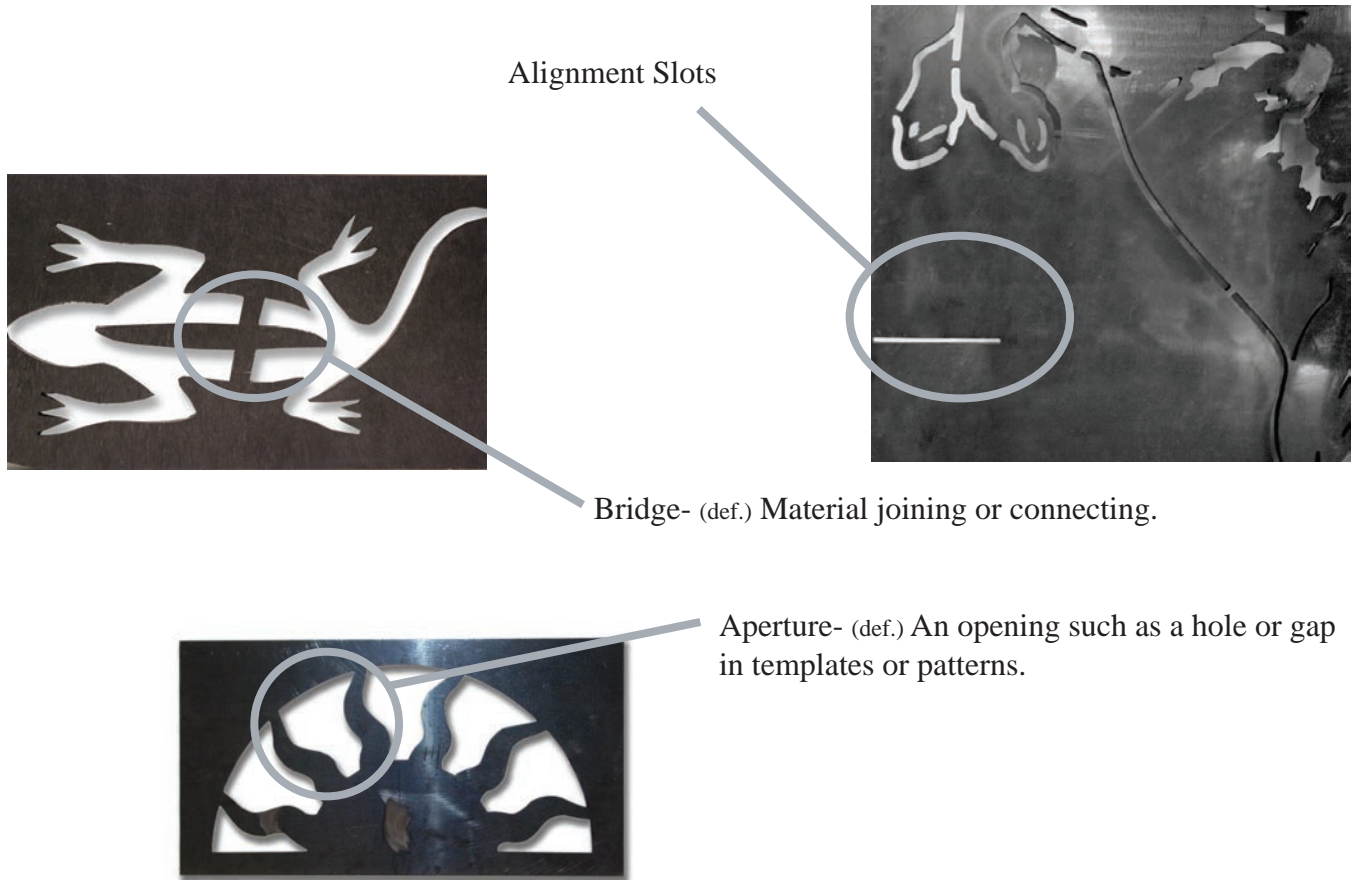

Cutting Integral Bridges



Some integral bridges will leave a bridge shadow. The shadows could be removed to complete the pattern.

Or some templates have pictorial bridge shadows. Removal is optional.



Some patterns have two templates. The first template will leave integral bridge shadows. The second template will be used to cut out the shadows.



Some templates leave several bridge shadows that are a necessary part of the design and therefore the shadows do not need to be removed. Only one template is used to complete for this type of pattern.

Note- use chalk lines to help align and keep the templates straight.
Use orange chalk.

Do Not Use RED Chalk
Red is PERMANENT!!

Cutting a Rotating Template Design

Determine the center of the pattern.

Using a hammer drill and the screws from the concrete anchoring kit, attach the template to the slab. Drill the hole more than deep enough for the screw. Then remove the dust from the hole by running the drill bit in and out of the hole several times.

Slide the sleeve over the drill bit.

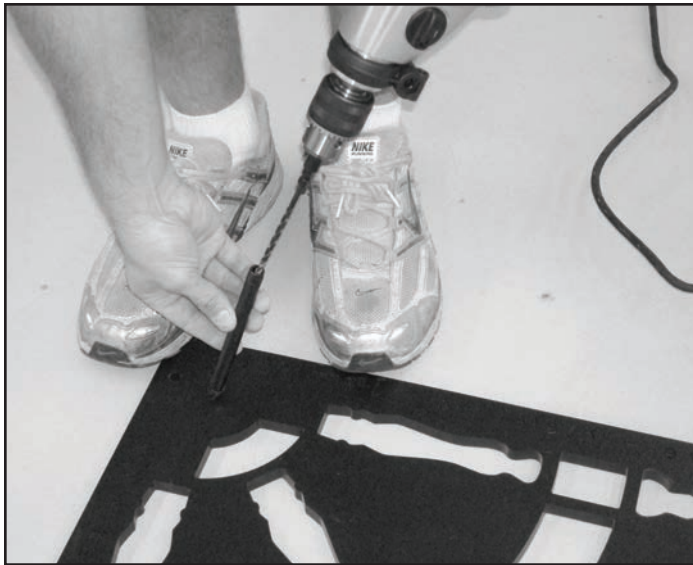

Install pivot screw

Leave screw slightly loose to allow template to pivot.

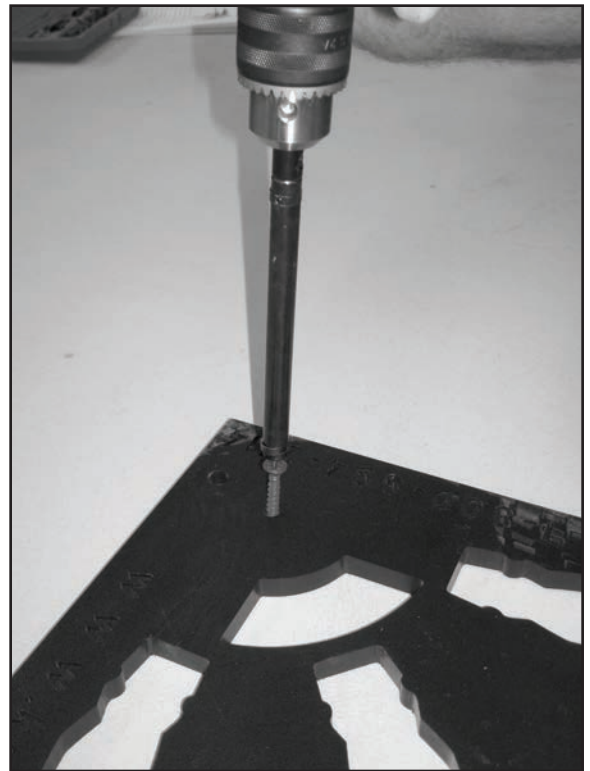

Concrete anchoring kit includes drill, driver and screws.



Determine the direction of the design.
Begin Cutting

Cutting Repeating Patterns

When cutting, the edges will stay crisp and sharp if a light touch and/or less air pressure is used. Many times too much downward pressure will cause the cut edges of the concrete to ravel, spall, chip and look ragged.



Tilt the tool to cut along the edges of the template.

Sight into the template apertures to check alignment with the cut.

Use the alignment slots when appropriate.

- Allow the tool to do the work. Maintain contact with the concrete surface with sufficient downward pressure only to keep the tool from bouncing off the concrete.
- When running off the edge of the concrete, use care and a light touch as this can damage and bend the Impactors.
- When cutting areas large enough to sight any misalignment of a pattern, snap a chalk line and use alignment slots.

Cutting Border Patterns

Layout Corner

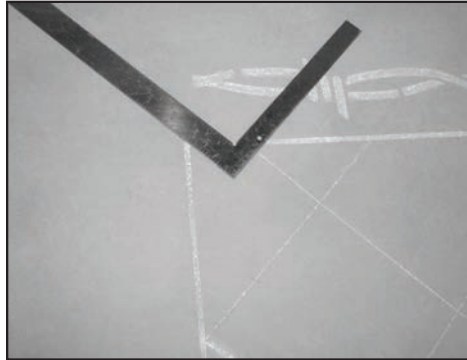

Mitre Corner



Lay out chalk line for first tile cut

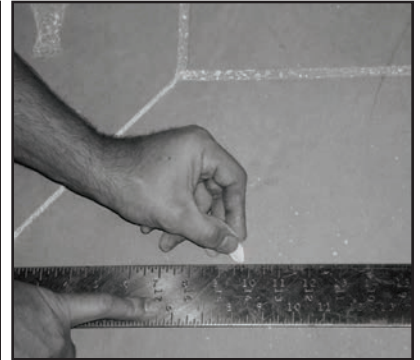

Snap chalk line

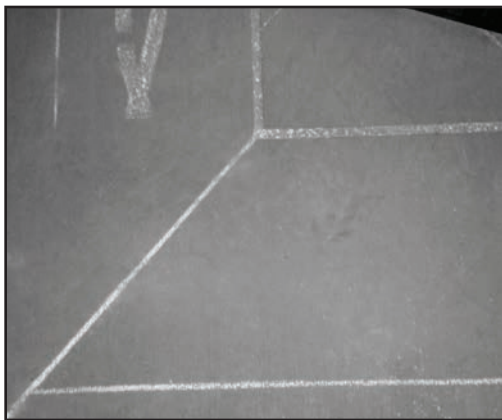

Align template slot marks with snapped chalk lines.

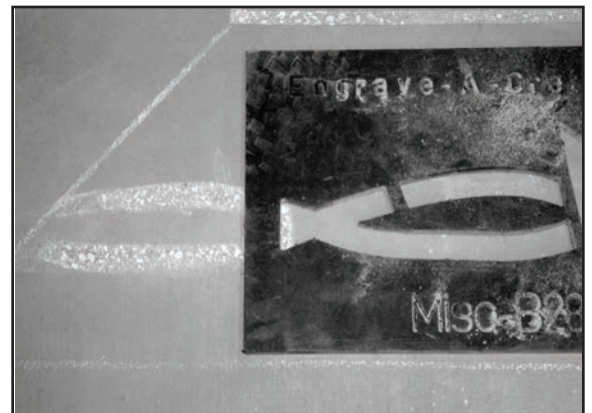

Cut Pattern



Move and Re-align Template



Hold template in place by either standing on it, or by anchoring it with concrete screws.

Cutting a Single Template



Place template on slab and align.

When cutting, place the impactors inside of the template openings and then squeeze the trigger. Starting the tool prior to placing the impactors inside the opening may damage the template.



When cutting next to the template edges, slightly angle the impactors toward the side of the template. This gives crisp edges on the design.



Cutting a Multi-Piece Pattern



When using a multiple piece template set, it is helpful to start by marking a cross hair in the center of the slab.

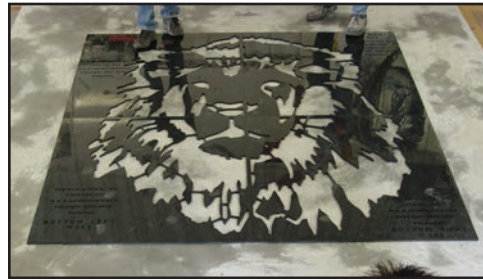

**Remember measure twice, cut once.
Engraving is permanent!**



Doing Touch Up Work with the Wasp



To start the tool, turn the sleeve valve indicator to the middle of the operating range. If the wasp is hissing, tap the tip of the stinger lightly against the concrete to engage the piston. (It is best to do this inside a cut area.) Once started, adjust the sleeve valve to provide the proper speed.

When cutting, **DO NOT** bear down on the tool and cause the stinger to dig into the surface. The Wasp is not a jack hammer. A Wasp will remove material faster with less downward pressure and therefore, less chance of breaking the stinger.

For best results, let the stinger do the work and guide the tool gently.



CAUTION:

Flying concrete chips and dust.

Approved safety goggles and /or a face shield, dust mask, plus PPE (Personal Protective Equipment) should be worn at all times when operating this or any other percussion tool.

Layout the areas with a pencil or chalk and use the wasp to remove the concrete.

A Bridge Shadow is an uncut area that was covered by a template bridge.



Cutting a 2-Piece Template Set

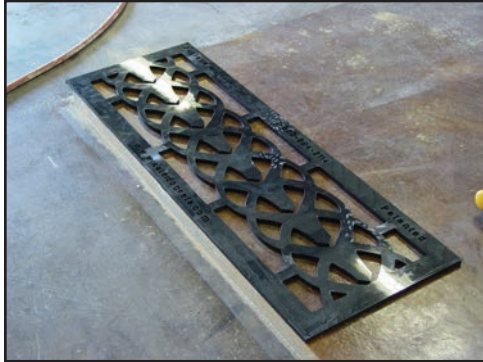

Double template sets are for quick bridge removal using either the shark or the barracuda.



First cut the main design.



Then lay the second template over the cut area and align with the design to remove the bridges.



Cutting a Half Template Pattern

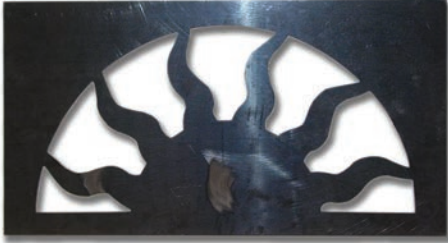

Align the first cut.



Rotate template 180 degrees, align and engrave second half



Cutting an Ashlar Slate Template Pattern

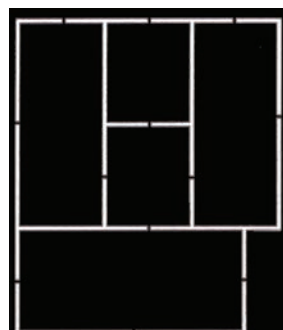
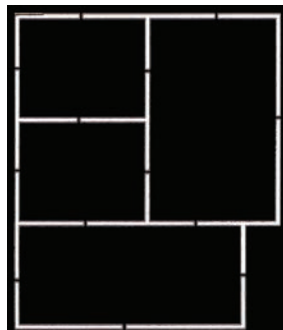
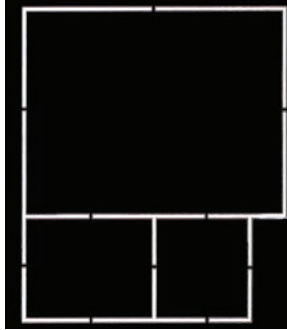

Always overlap your cut lines, nest templates with top left corner in same direction (If a template is turned the pattern will no longer nest) alternate using templates 1, 2, & 3 to make the stones look random this is a sample nesting. Note these lines do not overlap only to make this paper visually clear.

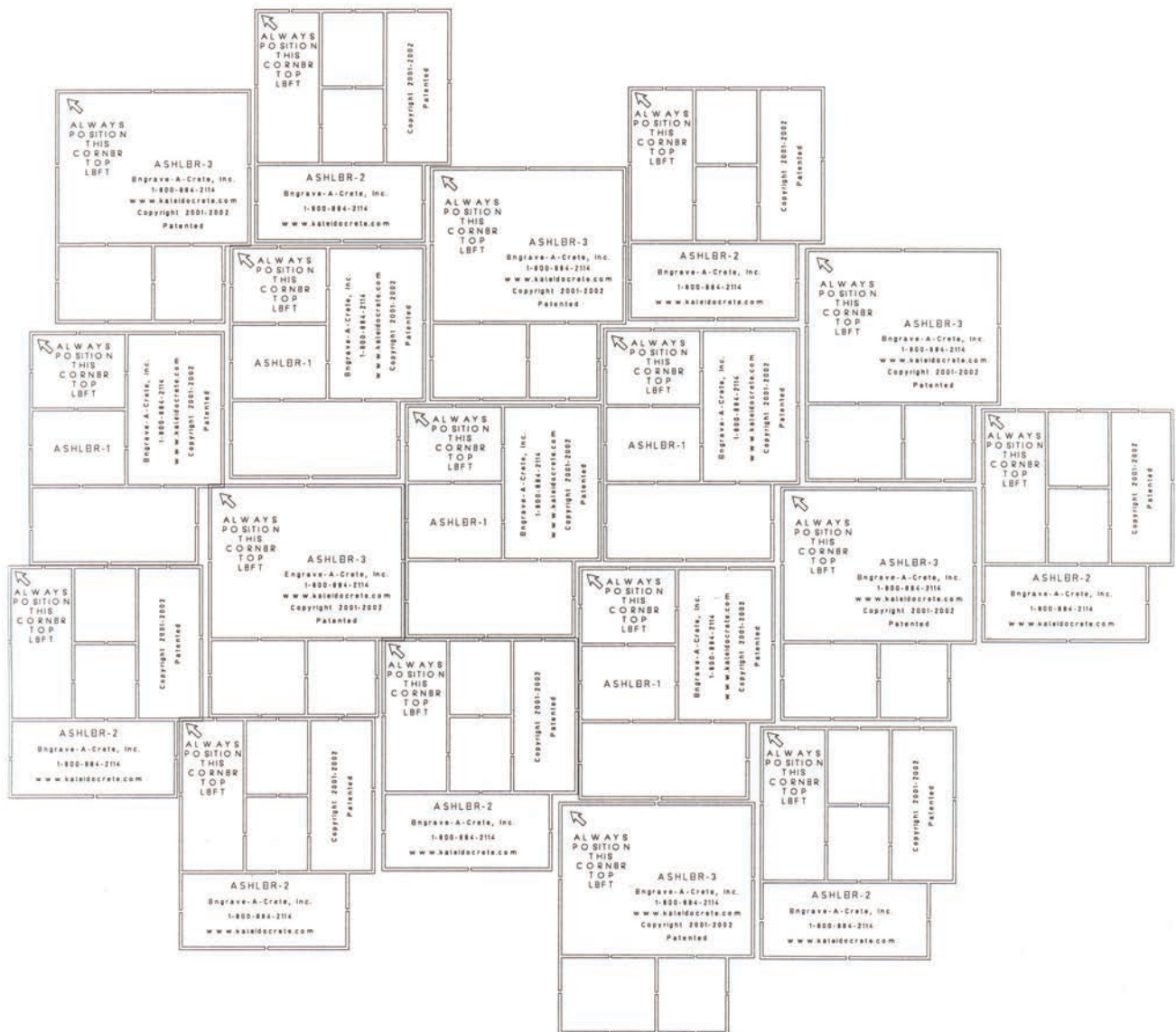

Cutting a Flagstone Template Pattern

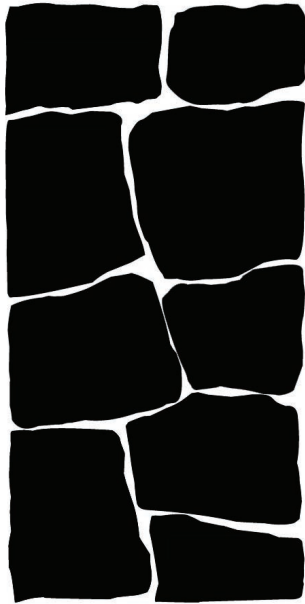

It is a good idea to lay out a few stones using soapstone to check for aesthetics of the design.



Align the stone templates.

Engrave around the perimeter of the template. Nest another stone template next to the cut just made and engrave around it.



Note: The further away you nest one template from your previous cut, the wider the resulting grout line.

Example: Corners of stones generally do not fit perfectly together. An edge of a template can be used to cut a large stone into two smaller stones.

To give realism to the design it is necessary to reshape stones. To do this use the edge of a template to alter edges. (Square off corners, create dimples in stone edges, widen some grout lines, etc.) This process can also be done using the wasp. When choosing stones to reshape, look to see if the shape is what you might see in real flagstone.

Stones will not always nest together perfectly. This leaves areas that will form a stone shape that does not resemble any of the templates. These are what give the design its unique randomness.

Cutting a Grout-line Template Pattern

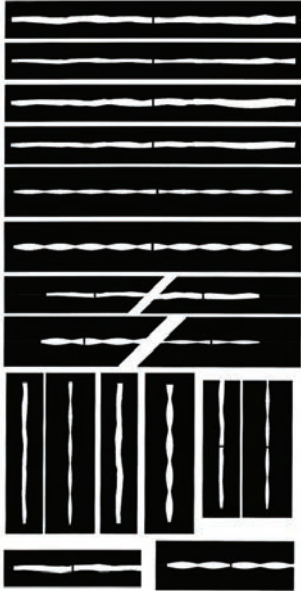

Step #1: With a chalk line layout a grid pattern.

Step #2: Use open-end template to complete the grout line up to the obstruction

Step #3: Remove the concrete where the template bridges were located. The templates can be used to remove the bridges or a wasp can be used freehand.

Additional Patterns: Any of the template designs may be used to cut nearly any pattern that can be laid out with a chalk line. Example: Tile, Diagonal Tile, Random Sized Squares etc.



Cutting a Fan Cobblestone Template Pattern

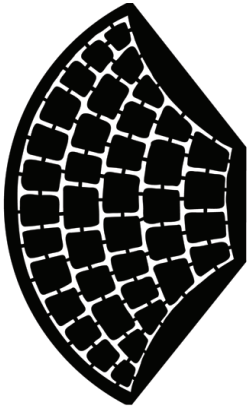

Step #1: Mark the Center Line of Slab with a Chalk Line

Step #2: Run the first Column of Fans Vertically up the Center Line – Continue Adding Fans on Either Side (the cut lines overlap to assure proper placement).

Step #3: Remove the concrete where the template bridges were located. The bridges can be removed freehand with a wasp.

When Completed Your Project Should Look Like This!

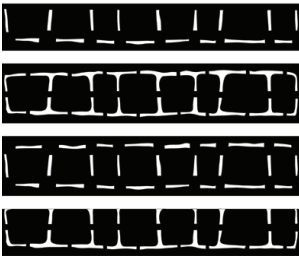

Cutting a River Rock Template Pattern

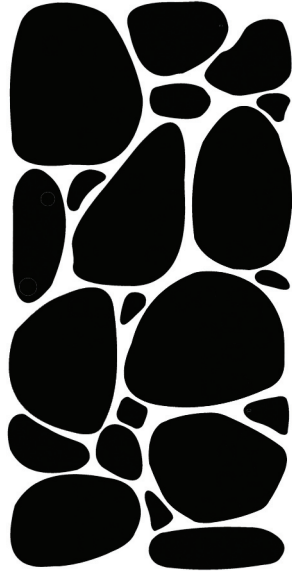

Step 1: Layout a few stones using soapstone to check for aesthetics of the design.

Step 2: Engrave around the perimeter of the template. Nestle another stone template next to the cut just made and engrave around it.

Note: The Further Away You Nest One Template From Your Previous Cut, the Wider the Resulting Grout

*Edges of templates may be used to create different shaped stones and to finish small areas left over where a template did not nest closely.

Odd shaped areas can be cut into a series of small stones with a Wasp





COPYRIGHT RELEASE AND INFORMATION FORM

COPYRIGHT INFRINGEMENT IS THE REPRODUCTION OF THIRD PARTIES' WORK THAT IS SUBJECT TO COPYRIGHT PROTECTION UNLESS A LICENSE TO REPRODUCE SUCH WORK HAS BEEN OBTAINED.

TRADEMARK INFRINGEMENT IS THE USE OF ANOTHER'S TRADEMARK IN A WAY THAT IS LIKELY TO CAUSE CONFUSION, MISTAKES OR DECEPTION AS TO SOURCE OF GOODS OR SERVICES.

You have submitted items such as photos, drawings, or other material and you have asked Engrave-A-Crete® to make patterns or templates for you. Engrave-A-Crete® will not copy an item which it knows is covered by the copyright of a third party and for which you do not have permission to copy. You must make sure that Engrave-A-Crete's copying of the items will not constitute copyright infringement or contribute to trademark infringement. Before Engrave-A-Crete will make templates or patterns of the items, you must confirm to Engrave-A-Crete that you have the right to have Engrave-A-Crete scan and/or copy items to construct a template(s) or a pattern(s).

In this regard, you, the undersigned, declare under penalty of perjury, represent and warrant to Engrave-A-Crete® that your intended use of the materials will not confuse or mislead the public in any way, and at least one of the following is true:

1. You own the copyright in the material or that it is your original work;
2. Or you have been authorized as the agent of the owner of the copyrighted item to have the item copied;
3. Or you have been granted a license by the owner of the copyrighted item to copy the item;
4. Or the material is in the public domain.

The undersigned acknowledges that Engrave-A-Crete® is relying upon the foregoing in agreeing to re-create the item. Accordingly, the undersigned shall indemnify, defend and hold Engrave-A-Crete harmless from any suit, demand, claim or liability arising from a breach of the foregoing warranty or any other basis arising from use of the templates, patterns or copies, including without limitation copyright infringement, trademark infringement and unfair competition. The undersigned shall pay any judgment or reasonable settlement offer and Engrave-A-Crete's cost and fees (including without limitation attorney's fees) incurred in connection with any such suit, demand, claim or liability, or in collecting upon this indemnification from the undersigned. Engrave-A-Crete may, if requested, provide a copy of this form to anyone claiming that Engrave-A-Crete's re-creating of the material infringes same's rights.

Customer Signature: _____ Customer Address: _____

Customer Name: _____ Today's Date: _____

Description of the items being copied: _____

Engrave-A-Crete®, Inc
403 North Oak
Mansfield, MO 65704
1-800-884-2114
1-417-924-2300
FAX 1-417-924-2500

When you need a custom template and using other's trademarked logo, please complete this form and return it with the logo or artwork.

IMPORTANT NOTICE: Concerning Copyrights

Amendments to the U.S. Copyright statutes in 1998 included a new section making it wrongful to “intentionally remove or alter” any one or more of the following items:

- The notice of copyright,
- The title of the work,
- The author’s name and other identifying information about the author,
- The copyright owner’s name and other identifying information about the copyright owner, or,
- “Terms and conditions for the use of the work.”

17 USC & 1202.

Violation of this section entitles the copyright owner to statutory damages between US\$ 2500 for a first offense by the defendant, or payment of actual damages, whichever are greater. For a subsequent offense by a defendant within three years, the damages may be tripled (i.e., statutory damages of a least US\$ 7500). In addition, the judge “may award reasonable attorney’s fees to the prevailing party”.

17 USC & 1203.

These new penalties for removing or altering a copyright notice give authors and owners of copyrights a new tool to prosecute plagiarists.

